

**KOMPAKT DC BØRSTELØST
SERVOSYSTEM**

Serie SanMotion R DC

R2GA04003F

- 40 - 60mm rammestørrelse
- 30 - 200W
- 48V DC / 25 - 40A
- Pulsstyring

**PRODUKTBESKRIVELSE**

DC servosystem med børsteløs motor i størrelse 30 - 200W.
Meget høy presisjon og ytelse.

TEKNISKE DATA

Akseldiameter	6 mm
Frontstørrelse	40x40
Hastighet nominell	3000 omdr/min
IP-klasse	IP67
Lengde	51,5 mm
Matespenning	48 V DC
Moment maks	0,37 Nm
Nominelt moment	0,098 Nm
Omgivelsestemperatur til	40 °C
Vekt	0,35 kg

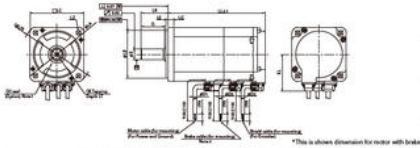

R2 Servo Motor High Efficiency and Low Ripple (Medium Inertia)

MODEL	Battery backup method				L1	L2	L3	L4	L5	L6	L7	L8	L9	L10	L11	L12	L13	L14	L15	
	1	2	3	4																
RS2AM03 ACC	51.5	51.5	54.5	52.5																
RS2AM04 ACC	56.5	52.5	51.5	51.5	0	35.4	48	0	20-0.021	2.5	58	43	2-0.15	25						
RS2AM05 ACC	77	108	77	77																
RS2AM06 ACC	55.5	52.5	55.5	55.5	4	44.4	73	20-0.025		0.2	40	4-0.15	25							
RS2AM07 ACC	59.5	57.5	70.5	50-5						1										
RS2AM08 ACC	69.2	102	79.2	100	8	54.4	90	20-0.030			100	30	4-0.15	30						
RS2AM09 ACC	56.5	122.5	102.5	100.5	8	48.4	79	20-0.025		0.2	30	4-0.15	25							
RS2AM10 ACC	76.2	114	85.2	121	4	44.4	90	20-0.020		1	100	30	4-0.15	40						
RS2AM15 ACC	107.5	143	114.5	150	8	59.4	100	20-0.022		2	100.5	30	4-0.15	30						
RS2AM16 ACC	137	169	137	169	8	59.4	100	20-0.022		2	100.5	30	4-0.15	30						

MODEL	0	G	DF	LF	DF	DF	DF
RS2AM03 ACC	0						
RS2AM04 ACC	0						
RS2AM05 ACC	0	20					
RS2AM06 ACC	0						
RS2AM07 ACC	0						
RS2AM08 ACC	0						
RS2AM09 ACC	0	140.000	20				
RS2AM10 ACC	0						
RS2AM15 ACC	0						
RS2AM16 ACC	0						

■ Servo Amplifier

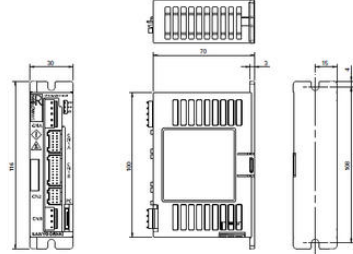

Mass : 0.23kg